



MP01 External Antenna Installation Guide

Version: V1.0

2011-4-10

This guide shows you how to install the external antenna for MP01 to extend the Wifi range. Except the built in omnidirectional PCB antenna, MP01 provides a I-PEX connector for external antenna.

Deployment Scenario

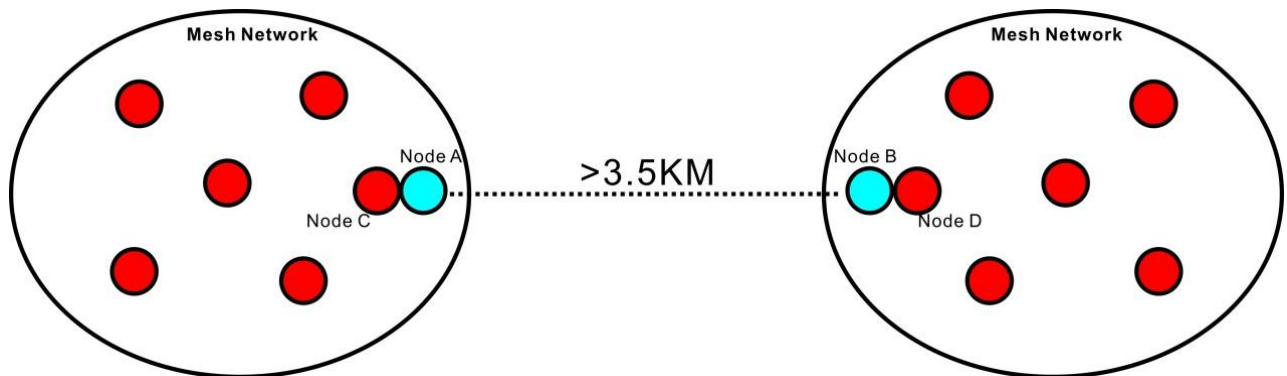

In the picture, the blue node is the MP01 with external directional antenna, the red one is a normal MP01. This network topology is a recommended deploy scenario. Assume that there are two villages using the MP01 and they are at least 3KM far away. In this situation, we can install external antenna for the MP01 to extend the Wifi range. Node A and Node B should be point to point. After deploying blue nodes, you need to deploy additional MP01 (Node C and Node D in the picture) near it. Because of directional antenna, the other red nodes can hardly receive signal from the blue one, so we need a normal MP01 with omnidirectional antenna to relay the signal.

Antenna Installation

- 1) We take the panel antenna for example. The following pictures show the instruction to fasten the antenna on the pole.

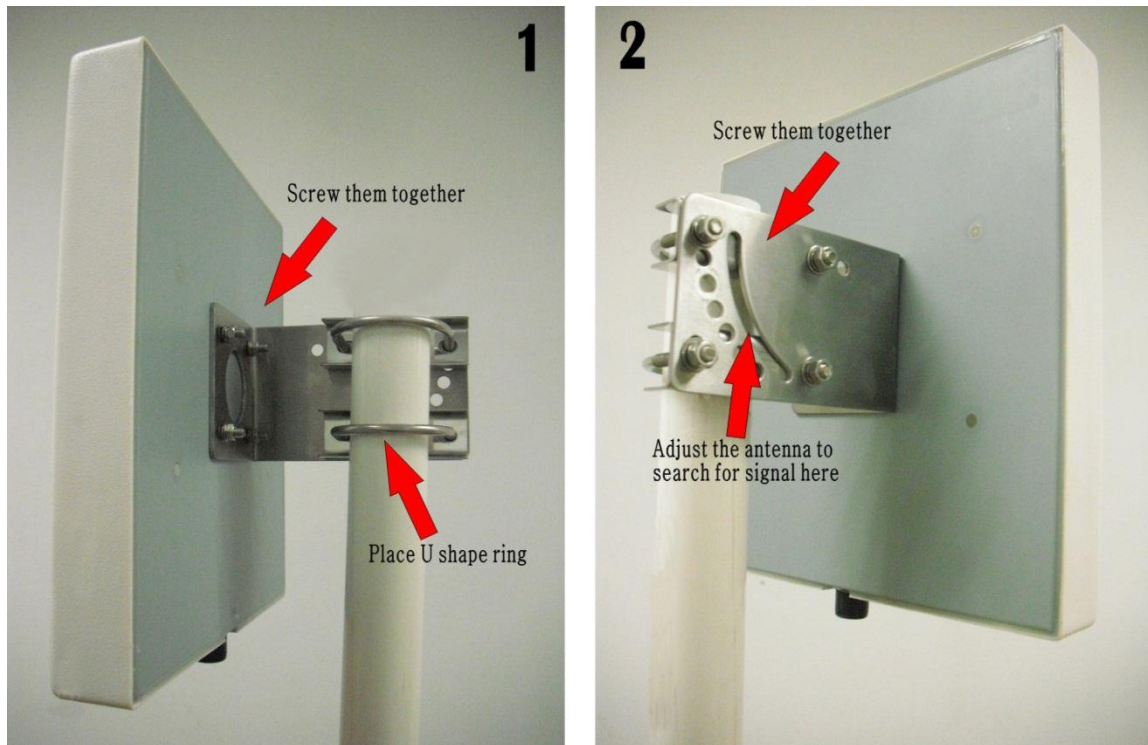

- 2) After mounting the panel antenna on the pole, connect the panel antenna and MP01 by antenna feeder.

